

USE AND CARE GUIDE

OUTDOOR WIRELESS REMOTE CONTROL

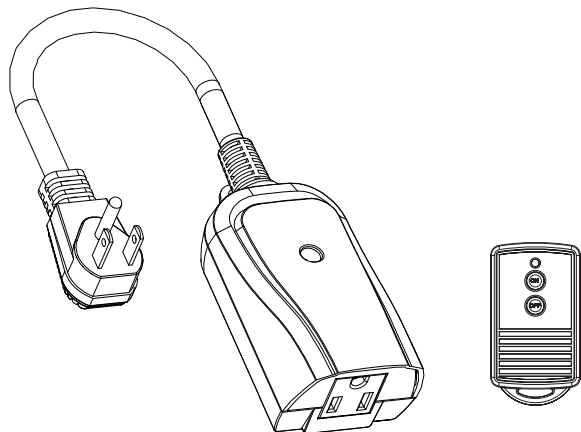

Safety Information

Federal Communications Commission Interference Statement

This equipment has been tested and found to comply with the limits for Class B digital device, pursuant to part 15 of the FCC Rules. These limits are designed to provide reasonable protection against harmful interference in a residential installation. This equipment generates, uses and can radiate radio frequency energy and, if not installed and used in accordance with the instructions, may cause harmful interference to radio or television reception, which can be determined by turning the equipment off and on, the user is encouraged to try to correct the interference by one or more of the following measures:

- Reorient or relocate the receiving antenna.
- Increase the separation between the equipment and the receiver.
- Connect the equipment into an outlet on a circuit different from that to which the receiver is connected.
- Consult the dealer or an experienced radio/TV technician for help.

1

Installation Instructions

Installing the remote outdoors

WARNING: The device must be mounted in a vertical position with the receptacle facing downward and with the receptacle at least 2 ft. above the ground level to prevent water immersion.

- Mount the receiver onto a wall near a grounded electrical outlet.
- Insert a nail or screw (not included) into the mounting surface. Nail or screw head must extend at least 3/16 in. out from the wall. Hang the receiver from the slot on back of the unit onto the nail or screw. Plug the power supply cord of the receiver into the outlet.
- Plug the device cord into the receptacle at the bottom of the receiver.

Operating Instructions

1 Using the remote control

- Plug the receiver into an outlet. Plug the devices to be controlled into the outlets on the receiver.
- To activate the receiver, press the "ON" button of the remote control. The red LED of the remote control will illuminate momentarily and the LED of the receiver will remain illuminated.
- To turn the receiver OFF, press the "OFF" button of the remote control. The LED on the receiver will shut off.

Maintenance

2 Replacing the battery

WARNING: Do not mutilate or place the battery in a fire. The battery may burst or release toxic materials. Do not short circuit or reverse polarity as this may cause burns.

- Remove the battery compartment cover from the back of the remote control by sliding the cover in the direction that its threads curve.
- Remove the old battery and place a new DC 12V Type A23 battery into the battery compartment, correctly observing the polarity indications (+/-) inside the battery compartment.
- Replace the battery compartment cover.
- Dispose or recycle spent/discharged batteries in compliance with all applicable laws. For detailed information, contact your local solid waste authority.

3

This device complies with Part 15 of the FCC Rules. Operation is subject to the following two conditions: (1) This device may not cause harmful interference, and (2) this device must accept any interference received, including interference that may cause undesired operation of the device.

FCC Caution: Any changes or modifications not expressly approved by the party responsible for compliance could void the user's authority to operate this equipment.

RATINGS

125 VAC, 60 Hz	1000 W Tungsten
13 A General Use	500 VA electronic ballast. 1/2 hp.
13 A Resistive	120 Vac, 60Hz, 8.3A ballast.

Product Description

NOTE: This product is suitable for indoor and outdoor locations.

- 1. Power indicator light:**
The power indicator light indicates that the receiver is on.
- 2. Outlets:**
The outlet located on the bottom of the receiver. Plug the light or device to be controlled by the remote into the outlet.
- 3. Remote control:**
 - ON: When the on button is pressed, it will override the receiver's current program to on function.
 - OFF: When the off button is pressed, it will override the receiver's current program to off function.
 - Remote indicator light: The LED light indicates that the ON or OFF button is being pressed.

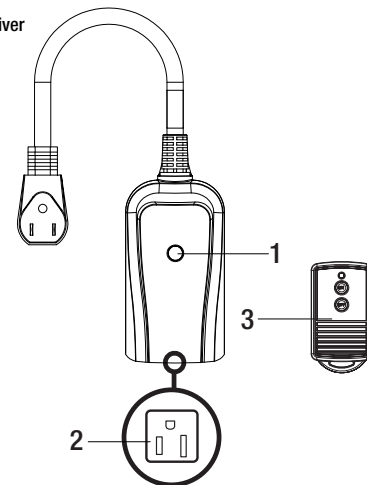

2

- Always purchase the correct size and grade of battery most suitable for the intended use.
 - Replace all batteries of a set at the same time.
 - Clean the battery contacts and also those of the device prior to battery installation.
 - Ensure the batteries are installed correctly with regard to polarity (+ and -).
- Caution: Failure to properly align the battery polarity can cause personal injury and/or property damage.
- Remove batteries from equipment which is not to be used for an extended period of time.
 - Remove used batteries promptly.

3 Remote control unit

- RF (radio frequency) transmitter is powered by one 12V A23 alkaline battery. Red indicator light (1), flickers when transmitting. Remote operates the indoor receiver/switch. Chain and key ring (2), for pocket or purse key ring use.
- Replace battery when red indicator light (1), does not flicker when a button is pressed. Remove battery cover a, to replace the A23 12V battery b.

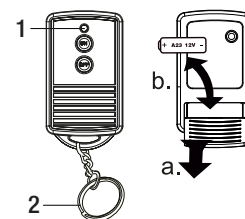

Troubleshooting

Problem	Solution
The lights do not turn on and off via remote control.	Confirm remote operation after replacing batteries.
The lights do not turn on, even when the power indicator light indicates that the receiver is on.	Ensure the lights are functional by plugging them directly into an outlet. Be sure that the lights are in the "ON" position if they have their own switch. Be sure that the outlet that the receiver is plugged into is active.

Made in China

SAVE THESE INSTRUCTIONS!

Xodus Innovations
2025 Yore Avenue
Benton Harbor, MI 49022
www.xodusinnovations.com

4